

KIT RICAMBI – SPARE KITS

KIT NR.	KIT 70
Posizioni incluse Positions included	4 - 7 - 8 - 9 - 10 11 - 12 - 13 - 15 - 16 22 - 24 - 25 - 28 - 29
Nr. Pcs.	1

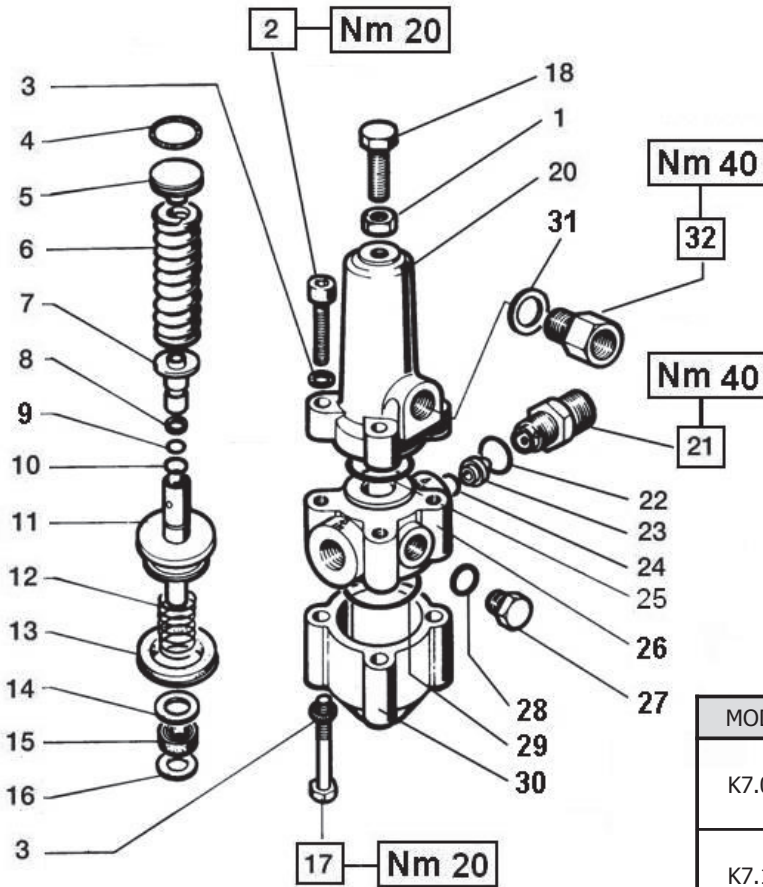

K7

DIS. COD. 36.9508.00

*** TABELLA A – TABLE A

MOD	POS	COD.	DESCRIZIONE - DESCRIPTION	NR
K7.0	21	10.0078.70	Nipplo G 3/8" con foro Ø 3	1
	23	10.0076.66	Ugello Ø 2.2	1
	32	36.3117.70	Nipplo G 3/8"	1
K7.1	21	10.0078.70	Nipplo G 3/8" con foro Ø 3	1
	23	10.0076.66	Ugello Ø 2.5	1
	32	36.3116.70	Nipplo G 3/8"	1
K7.2	21	10.0160.70	Nipplo G 3/8" con foro Ø 3.25	1
	23	10.0162.66	Ugello Ø 2.75	1
	32	36.3118.70	Nipplo G 3/8"	1
K7.3	21	10.0161.70	Nipplo G 3/8" con foro Ø 3.5	1
	23	10.0163.66	Ugello Ø 3	1
	32	36.3119.70	Nipplo G 3/8"	1

POS	COD.	DESCRIZIONE – DESCRIPTION KIT	NR
1	92.2368.00	Dado M10x17x6 UNI 5589	1
2	99.3084.00	Vite M8x30 UNI 5931	4
3	96.7014.00	Rosetta Ø 8.4x13x0.8	8
4	90.3849.00	OR Ø 20.63x2.62 (128)	70 1
5	36.3095.70	Piattello molla	1
6	94.7466.00	Molla Ø 17x60	1
7	36.3094.66	Sede valvola	70 1
8	90.5052.00	Anello antiest. Ø 9.6x14x1.5	70 1
9	90.3820.00	OR Ø 9.13x2.62 (109)	70 1
10	90.3582.00	OR Ø 9.25x1.78 (2037)	70 1
11	36.3097.02	Assieme pistoncino e sfera	70 1
12	94.7464.00	Molla Ø 17x17	70 1
13	90.2766.00	Anello ten. alt. Ø 30x40x7	70 1
14	96.7215.00	Rosetta Ø 13x20x2	1
15	90.2565.00	Anello ten. alt. Ø 10x18x5.5	70 1
16	90.5063.00	Anello antiest. Ø 10x18x1.5	70 1

POS	COD.	DESCRIZIONE – DESCRIPTION KIT	NR
17	99.3127.00	Vite M8x45 UNI 5737	4
18	99.3663.00	Vite M10x25 UNI 5740	1
20	36.3090.41	Corpo valvola superiore	1
21	***	Vedi tabella A – See table A	-
22	90.3833.00	OR Ø 13.95x2.62 (3056)	70 1
23	***	Vedi tabella A – See table A	-
24	90.3823.00	OR Ø 9.92x2.62 (112)	70 1
25	90.3863.00	OR Ø 28.25x2.62 (3112)	70 1
26	36.3091.41	Corpo valvola centrale	1
27	98.2041.00	Tappo G 1/4"x9	2
28	90.3585.00	OR Ø 10.82x1.78 (2043)	70 2
29	90.3871.00	OR Ø 34.6x2.62 (3137)	70 1
30	36.3092.41	Corpo valvola inferiore	1
31	96.7380.00	Rosetta Ø 17.5x23x1.5	1
32	***	Vedi tabella B – See table B	-